

Notes:

1. The conservation easements of the Lynde Point Land Trust, Inc. depicted herein are described in the following deeds recorded in the Town of Old Saybrook land records:

| Volume | Page |
|--------|------|
| 313 | 588 |
| 313 | 595 |
| 372 | 624 |
| 372 | 624 |

The easement areas therein are described generally based on a map entitled: "Map of New Saybrook No. 2", Scale: 1"=420' approximately. Prepared by: Wm. R. Clarke, C.S. and recorded in the Town of Old Saybrook land records as Town Clerk's Map No. 27.

2. The parcel and street lines depicted herein have been reproduced from the Town of Old Saybrook Assessor's Map numbers 5, 9, 10 and 11. These maps and recent aerial photographs were used as the base information for this map. The intent of this map is to depict the general location of the conservation easements described in the deeds referenced above. These locations are subject to revision as additional research and accurate field surveys may disclose.

3. The land parcel owned in fee by the Lynde Point Land Trust, Inc. depicted herein is described in a deed recorded in Volume 372, Page 631 in the Town of Old Saybrook land records.

4. The following is an overview of both the permitted and prohibited uses and activities within the areas under conservation easement:

| Permitted Uses and Activities | Prohibited Uses and Activities |
|--|---|
| Golf Course Construction and Maintenance | New Construction |
| Road and Path Maintenance | Changes in Topography |
| Installation of Signage for Safety or Rules of Usage | Spraying or Chipping of Trees or Plants |
| Mowing and Spraying for Insect Control | Dumping |
| Institution of Wildlife | Changes in Watercourses |
| | Use of Motor Vehicles (Except for Maintenance) |
| | Hunting or Trapping (Except to Maintain Ecological Balance) |
| | Upgrading of Roads or Paths (Except for Maintenance) |

The Lynde Point Land Trust, Inc. may enforce the above uses and activities and may request correction within thirty days.

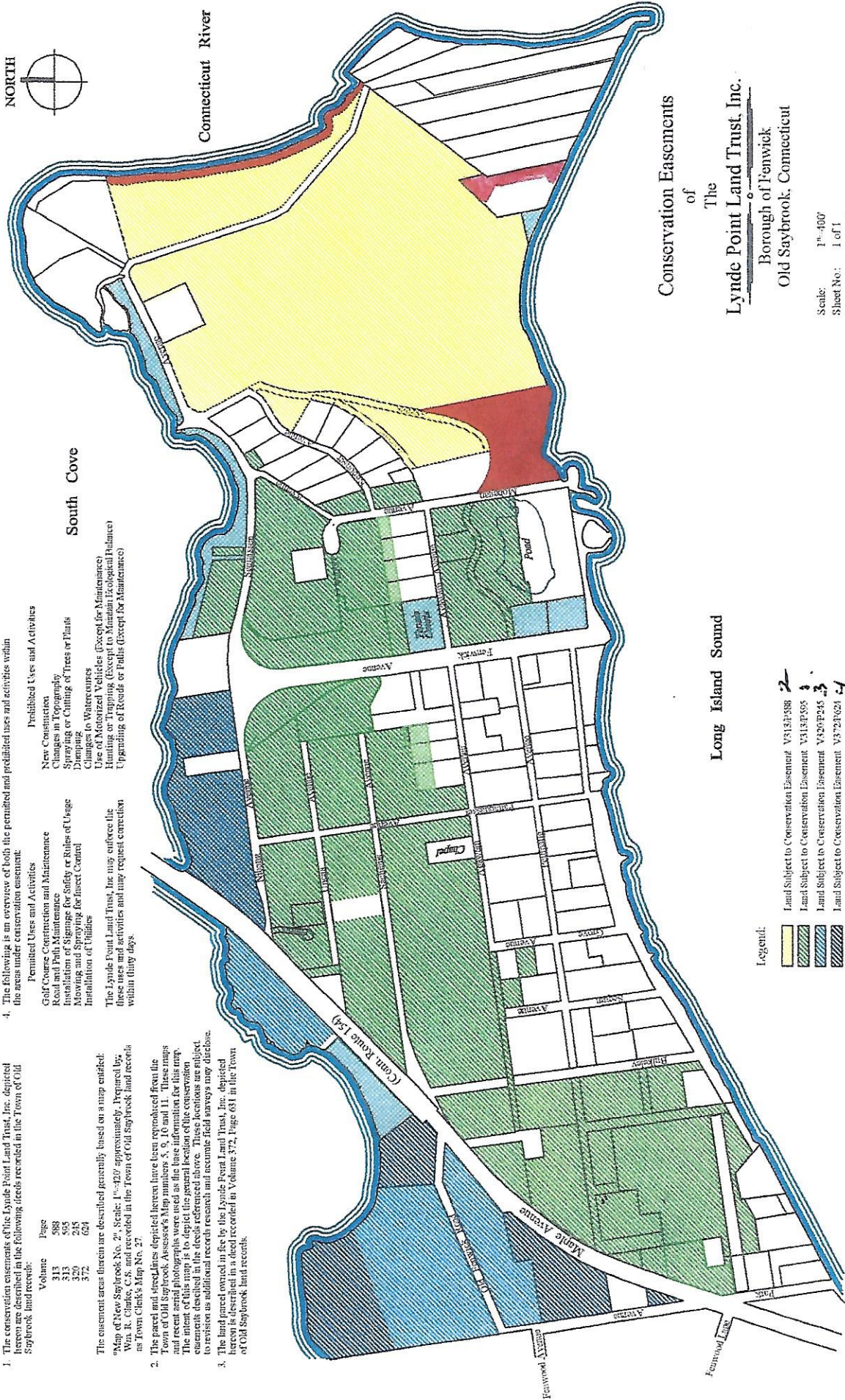

Conservation Easements
of
The
Lynde Point Land Trust, Inc.
Borough of Fenwick
Old Saybrook, Connecticut

Scale: 1"=400'
Sheet No: 1 of 1
Date: September 2, 2005

Long Island Sound

Legend:

| | | |
|--------------|--|---|
| [Yellow Box] | Land Subject to Conservation Easement V313P588 | 2 |
| [Green Box] | Land Subject to Conservation Easement V313P595 | 3 |
| [Blue Box] | Land Subject to Conservation Easement V320P245 | 3 |
| [Red Box] | Land Subject to Conservation Easement V372P624 | 4 |
| [Blue Box] | Land in Fee Ownership V372P631 | |
| [Blue Box] | Borough Owned - Non-Easement | |
| [Blue Box] | Private Owned Lensed to Borough | |